

INSTALLATION AND HANDLING INSTRUCTIONS

CLEAR LAM® V-Rustic Siding

HANDLING AND STORAGE

1. All CLEAR LAM® V-Rustic siding must be stored in a roofed structure so as not to allow direct exposure to weather and the elements. Bundle wrap must remain intact so that the panel ends are not exposed to blowing rain, snow, etc.
2. After the siding bundle has been opened, it must be stored off the ground, flat and well supported on 3 1/2" stringers set a maximum 4 feet apart. Keep the material dry by wrapping loosely with plastic so that air may circulate.
3. During handling, care must be taken not to rupture the V-Rustic siding surface or otherwise break the factory-applied prime coat. If the prime coat is accidentally broken, you should reprime the damaged area with an unthinned 100% acrylic latex primer.

INSTALLATION

1. *At the jobsite, CLEAR LAM® V-Rustic siding must be kept clean and dry prior to installation.* Storage in a roofed structure would be advisable. Keep the material dry by wrapping loosely with plastic so that air may circulate. It is highly recommended that the material be allowed to equilibrate at the jobsite for at least two weeks prior to installation.
2. CLEAR LAM® V-Rustic siding is *factory sealed* and we do not recommend that the product be ripped in the field. In the event that ripping is a necessity, the fresh wood edge should be primed with an unthinned 100% acrylic latex primer. Next, the primed edge should be sealed with a high-quality, all season weatherproofing sealant. For best results, use a product that meets ASTM-C920S.
3. End cuts and miter cuts across the product's width are permitted, however, the fresh wood must be primed and re-sealed using an unthinned 100% acrylic latex primer. Provide a slight gap for beveled end joints. Seal with a high quality, all season weatherproofing sealant. For best results, use a product that meets ASTM-C920S.
4. For cutting, use a fine-tooth saw blade for the cleanest cut. Cut from the backside of V-Rustic siding when using a power saw with a combination blade or saber saw with a fine tooth blade. When cutting with a cross cut handsaw, use it from the front side of the V-Rustic siding. *It is mandatory that all fresh cuts be primed with an unthinned 100% acrylic latex primer.*
5. Only use noncorrosive nails, which are intended for wood siding. Pre-drill holes to prevent splitting at mitered corners or at ends. **When face nailing, the nail should be driven so the head does not go below the MDO surface.** Any accidental open voids should be filled with a paintable, a high-quality latex or polyurethane caulk, or solvent based putty. Always use primed bevel cuts for end joining. Position each siding piece so that a 1/16" expansion gap is present at the V-groove. To help minimize swelling of the MDO face, fill open knots and voids at the V-groove with a paintable, high quality latex or polyurethane caulk material.
6. Good construction techniques must be followed to assure that moisture will not accumulate on the back of CLEAR LAM® V-Rustic siding. Use a vapor barrier with a rating of 1 perm on the warm side of the wall. Water-resistant building paper with a rating of at least five perms should be applied over exterior sheathing. Do not use exterior sheathing other than plywood or OSB.
7. In the rare event that the MDO face becomes broken or damaged due to accidental impact, the affected area can be repaired with a high quality two-part epoxy. Be sure to follow the manufacturer's instructions.

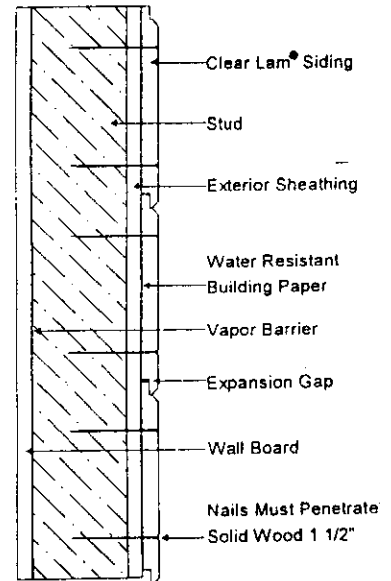

For widths less than 8-inch, use one nail per bearing with the nailing point one inch from the overlapping edge. For widths eight inches and wider, face nail with two nails per bearing. Position nails one-quarter the width of the material in from each edge.

FINISHING

1. CLEAR LAM® V-Rustic siding should be finish-painted with an unthinned 100% acrylic latex exterior paint that is intended for wood siding. A minimum of two coats of a major national brand totaling a dry thickness of three (3) mils is required. The use of solvent/oil based finishes is prohibited due to its brittle nature.
2. Paint finish must be applied and maintained according to the paint manufacturer's specifications. Use a paint that contains a mildewcide in geographical areas where mildew is common. Apply paint to the V-grooves with a brush so that the primed wood surfaces are thoroughly coated.
3. CLEAR LAM® V-Rustic siding must be finish-painted within 60 days after installation. If exposed for a longer period of time, some sanding may be required along the V-groove to remove raised grain. Sanding of the face should be minimized. Reprime with an unthinned 100% acrylic latex primer.

NOTE: AFTER THE PRODUCT HAS EQUALIZED TO LOCAL AMBIENT CONDITIONS, SOME DEGREE OF RAISED GRAIN MAY BE EVIDENT THROUGH THE MDO SURFACE. THIS MAY BE ESPECIALLY EVIDENT IN THE AREAS ADJACENT TO THE FINGERJOINT AND NAIL HOLES.